

Drawing No.:

101102003

Model:

PE105F1R420-A

Customer:

SUBMITTAL

Drawn By:

NJ 6/4/15

Date:

Rev.

-

Date

-

Description

Notes:

- 1. Options added to the chiller equipment (i.e. pumps, heat recovery, tank size, etc.) may affect the configuration (i.e. weight, dimensions, electrical requirements, etc.). Please verify final configuration of equipment.
- 2. Dimensional tolerance: +/- .2" nominal.

PRO Refrigeration, Inc.

336 8th Street SW Auburn, WA 98001
T: (253) 735-0466 / F: (253) 735-2831
www.prochillers.com



ELECTRICAL SPECIFICATIONS (GHP):
 MAIN VOLTAGE: 230V/1PH/60HZ
 MINIMUM CIRCUIT AMPACITY (MCA): 47 AMPS
 MAXIMUM OVERCURRENT PROTECTION (MOP): 75 AMPS
 MAIN VOLTAGE: 230V/3PH/60HZ
 MINIMUM CIRCUIT AMPACITY (MCA): 35 AMPS
 MAXIMUM OVERCURRENT PROTECTION (MOP): 57 AMPS
 MAIN VOLTAGE: 460V/3PH/60HZ
 MINIMUM CIRCUIT AMPACITY (MCA): 18 AMPS
 MAXIMUM OVERCURRENT PROTECTION (MOP): 29 AMPS
WEIGHT SPECIFICATIONS (GHP):
 ESTIMATED SHIPPING WEIGHT (CRATED): APPROX. 1,150 LBS
 ESTIMATED OPERATING WEIGHT: APPROX. 1,050 LBS

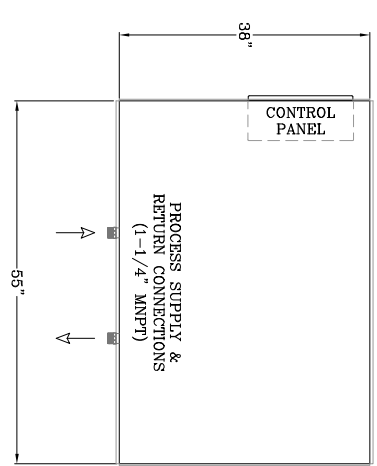

PLAN VIEW

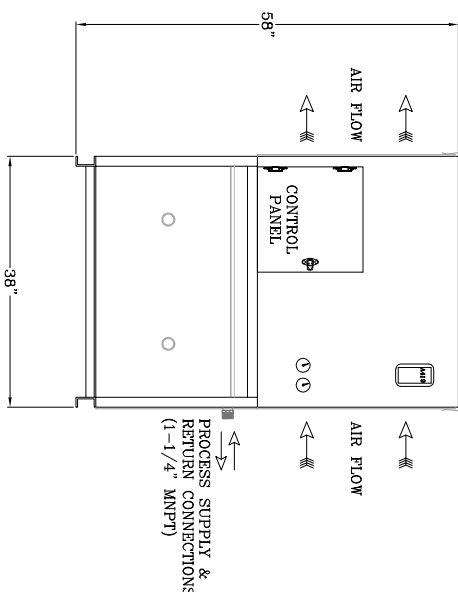

FRONT ELEVATION

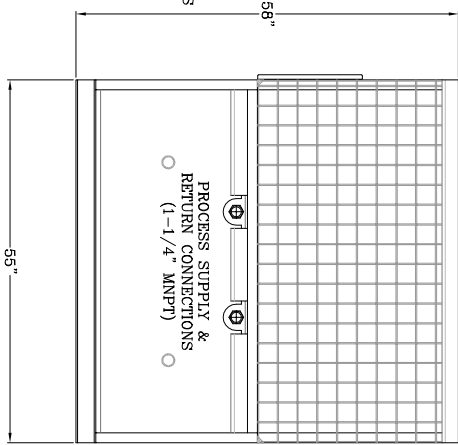

SIDE ELEVATION 1

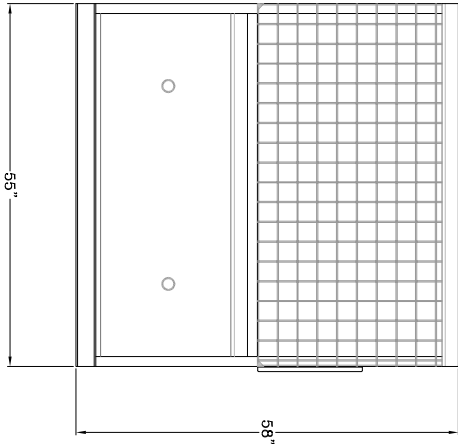

SIDE ELEVATION 2