

ELECTRICAL SPECIFICATIONS (2HP):
 MAIN VOLTAGE: 230V/1PH/60HZ
 MINIMUM CIRCUIT AMPACITY (MCA): 26 AMPS
 MAXIMUM OVERCURRENT PROTECTION (MOP): 39 AMPS

MAIN VOLTAGE: 230V/3PH/60HZ
 MINIMUM CIRCUIT AMPACITY (MCA): 18 AMPS
 MAXIMUM OVERCURRENT PROTECTION (MOP): 27 AMPS

MAIN VOLTAGE: 460V/3PH/60HZ
 MINIMUM CIRCUIT AMPACITY (MCA): 9 AMPS
 MAXIMUM OVERCURRENT PROTECTION (MOP): 14 AMPS

WEIGHT SPECIFICATIONS (2HP):
 ESTIMATED SHIPPING WEIGHT (CRATED): APPROX. 950 LBS
 ESTIMATED OPERATING WEIGHT: APPROX. 950 LBS

COOLING CAPACITIES:
 AT 90 °F AMBIENT
 25 °F GLYCOL: 15000 BTU/HR (4.4KW)
 30 °F GLYCOL: 16400 BTU/HR (4.8KW)
 35 °F GLYCOL: 17900 BTU/HR (5.2KW)

SOUND PRESSURE LEVEL:
 65 dB @ 1m

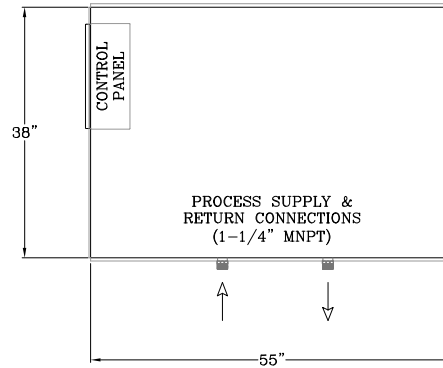

PLAN VIEW

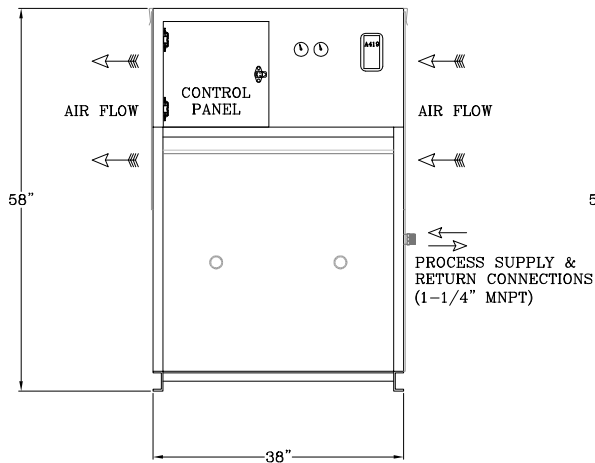

FRONT ELEVATION

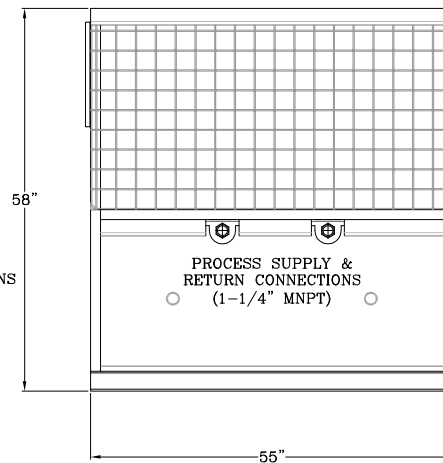

SIDE ELEVATION 1

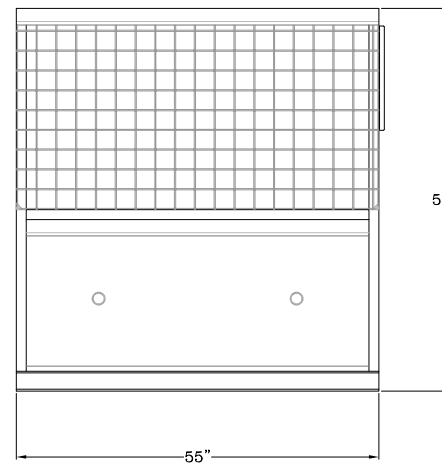

SIDE ELEVATION 2

Drawing No.:

101102001

Model:

PE102D1R420-A

Customer:

SUBMITTAL

Drawn By:

NJ

Date:

6/4/15

Rev.	Date	Description
9	2/23/16	MOVED TANK LOCATION AND FRAME MEMBERS

Notes:

- Options added to the chiller equipment (i.e. pumps, heat recovery, tank size, etc.) may affect the configuration (i.e. weight, dimensions, electrical requirements, etc.). Please verify final configuration of equipment.
- Dimensional tolerance: +/- 2" nominal.

PRO Refrigeration, Inc.

326 8th Street SW Auburn, WA 98001
 T: (253) 735-9466 / F: (253) 735-2631
 www.prochiller.com

